



## INTELLIGENT CONTROL FOR MODERN GAS EXTINGUISHING SYSTEMS

### Extinguishing control panels

design for single or multi-zone installations

BC06-1EXT

BC06-2EXT

LC216-1

LCnet216



## A DEPENDABLE AND INDIVIDUAL SOLUTION FOR CRITICAL APPLICATIONS

The ideal solution for complex fire protection requirements – bundling all reports and status information for effective extinguishing and alerting.

Fires require an immediate reaction. If a fire is detected, immediate alerting is necessary to save lives and protect valuables. A fire detection system forms the basis for this.

### WAGNER extinguishing control panels make up the heart of effective fire extinguishing

The extinguishing control panels BC06-1EXT, BC06-2EXT or LC216-1 and LCnet216 are used depending on system configuration. They ensure maximum speed and efficiency with their high-performance processor systems and many integrated functions.

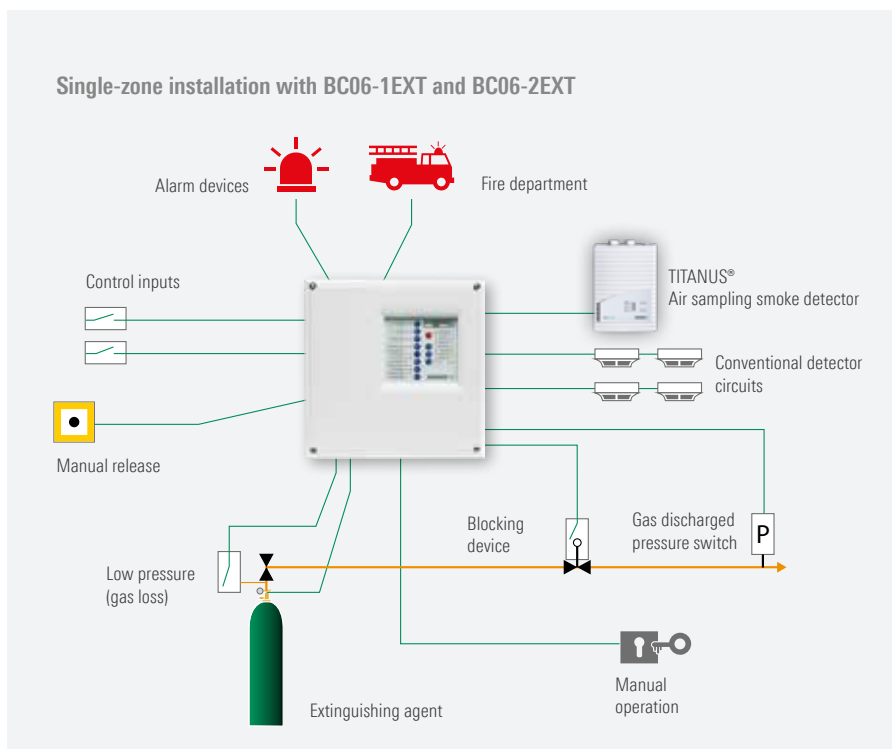

**Fire and extinguishing control panels type BC06-1EXT and BC06-2EXT**

The BC06-1EXT, BC06-2EXT and C06-2EXT are certified, combined fire and extinguishing control panels. They monitor detector groups in conventional detector circuits. Detector groups can be linked to activate alarm devices control the extinguishing system.

**Extinguishing control panels types LC216-1 and LCnet216**

Single and multi-zone installations for up to 127 extinguishing systems/zones. The connected extinguishing control panel can also be configured to be redundant. Base functions:

- Activation of valves and alarm devices
- With various authorisation levels

**Options for EN12094-1:**

- Individually settable pre-warning time for triggering delay
- Extinguishing agent flow monitoring

- Extinguishing system components
- Switching to manual mode
- Signals for fire control system outside of the extinguishing system (such as shutting down the air conditioning system)
- Activation of alarm devices with different alarm signals
- Secondary flooding initiation
- Release signals for reserve cylinders
- Extended discharge control
- Extinguishing agent release for selected extinguishing zones

Single and multi-zone installations with LC216-1 and linked LCnet216

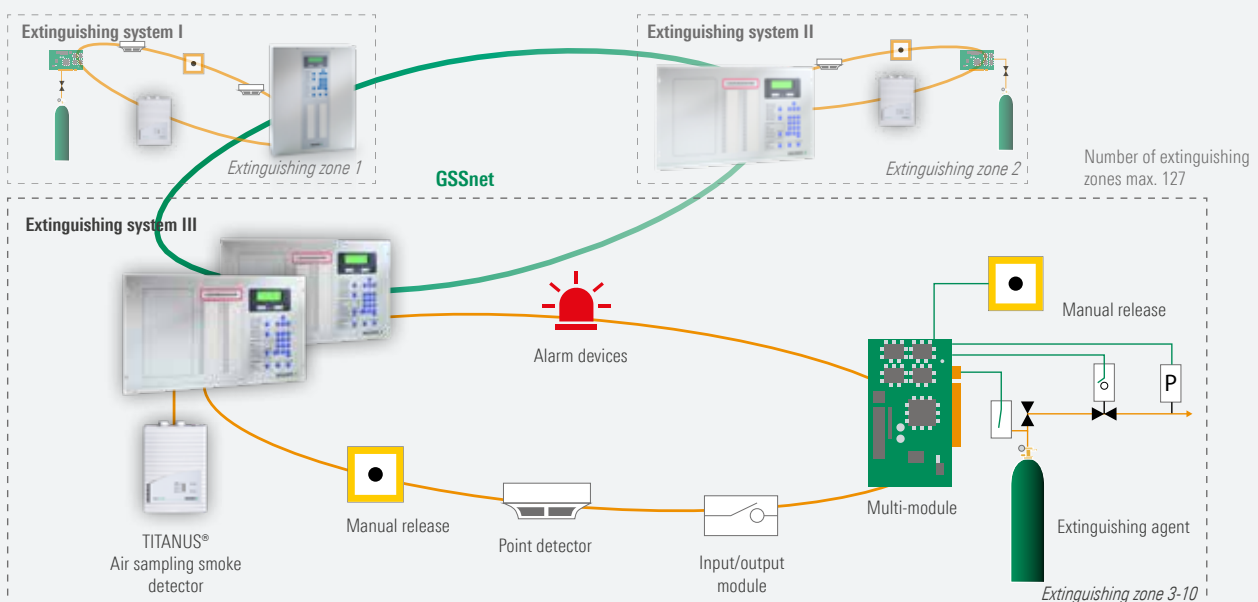

## Extinguishing control panels



Type designation	Compact fire and extinguishing control panels		Extinguishing control panel/or combined fire and extinguishing control panel	
	BC06-1EXT	BC06-2EXT	LC216-1	LCnet216
<b>Technical data</b>				
Wall housing dimensions (W x H x D mm)	330 x 330 x 90 mm		420 x 520 x 120 mm single-zone installation (multi-zone control unit in 19" wall/standing component)	
Material	Plastic		Sheet steel	
Weight	approx. 3.0 kg		approx. 7.2 kg single-zone installation	
Colour	grey-white, RAL 9002		grey-white, RAL 9002	
<b>Functions</b>				
Single-zone	one extinguishing zone		Single-zone or multi-zone installations	
Base furnishing incl.	4 detector lines and integrated extinguishing module (EXB1-1)		Event memory	
Non-resettable alarm counter (4-digit)	no	yes	yes	yes
<b>Configuration</b>				
Number of extinguishing zones	1	1	1	max. 127
Number of extinguishing zones per sub-control	-	-	-	8
<b>Operating specifications</b>				
Ambient temperature	-5 °C to +50 °C		-5 °C to +50 °C	
Bridging time	up to 72 hours		up to 72 hours	
<b>Approvals/guidelines</b>				
	CE 0786-CPD-20808		CE 0786-CPD-20267	
	EN 54-2, EN 54-4, EN 12094-1		EN 54-2, EN 54-4, EN 12094-1	
	VdS G209163		VdS G206046 as pure extinguishing control panel VdS G206089 as a combined fire and extinguishing control panel	

